





## 4 Trinity Close, Staines-upon-Thames, TW19 7PR

OPEN DAY SATURDAY 3RD SEPTEMBER. Viewing by appointment only.

This stunning extended four bedroom detached home is situated in a cul-de-sac location and needs to be seen to be fully appreciated.

Accommodation comprises of four bedrooms, study, garden room and large family room with bi-folding doors to the rear garden. Other notable features include a modern state of the art kitchen with island, utility room, downstairs shower room, family bathroom, upvc double glazing, driveway parking and landscaped low maintenance private rear garden. The property also benefits being within a short commute to Heathrow Airport and has superb road links to the M25, M4 & M3.



## Floor Plan

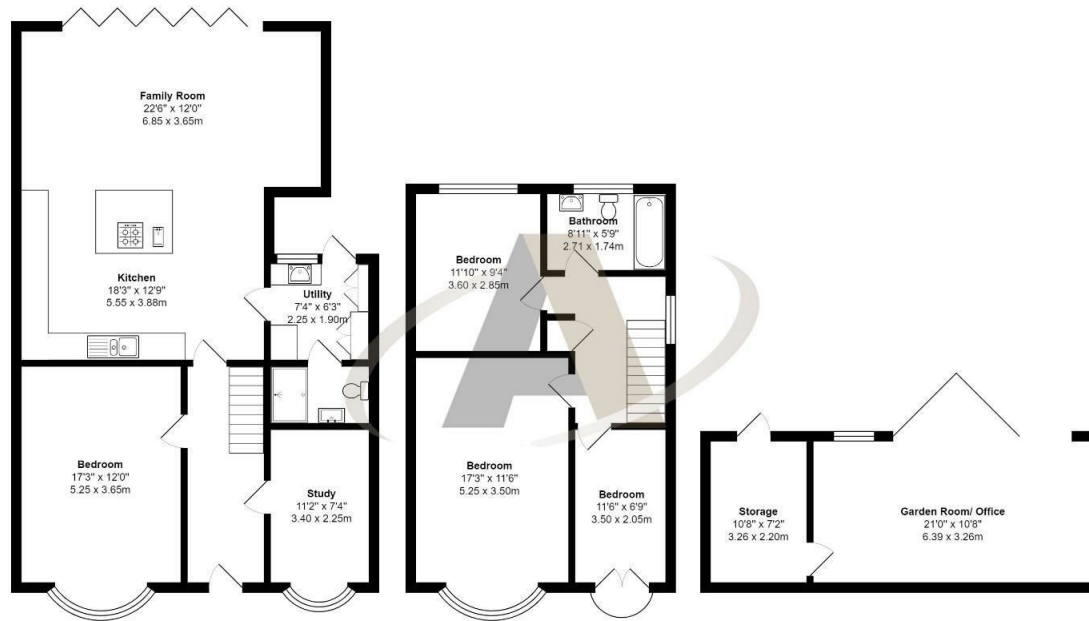

## Features

- Four Bedroom
- Family Room
- Private Rear Garden
- Utility Room
- Detached
- Modern Kitchen
- Garden Room
- Study

